

# APPENDIX

## Grand Park District District Vision & Regulating Plan

April 2025

01	List of Figures	01
02	Network Categorization & Street Sections	02
03	Linear Park Programming Concepts	13
04	Gateways and Vista Terminations	15
05	2024 Parcel Framework Plan	17
06	2026 Updated Parcel Framework Plan	
07	GPEC, Hotel, Office - Massing Concepts	
08	Winter Activation Concept Examples	



## APPENDIX 01

# List of Figures

Figure 1.1: Planning Context Map	04
Figure 1.2: Regional Connections	04
Figure 1.3: Grand Park District	05
Figure 1.4: Natural and Engineered Landscape	06
Figure 1.5: Image	07
Figure 1.6: Image	07
Figure 2.1: Organizing Concept	09
Figure 2.2: Illustrative Plan	09
Figure 2.3: Rendering	10
Figure 2.4: Key Plan - Highlighting North Area	12
Figure 2.5: Illustrative Plan	12
Figure 2.6: Rendering	13
Figure 2.7: Key Plan - Highlighting South Area	16
Figure 2.8: Illustrative Plan	16
Figure 2.9: South Area Birds - Eye Rendering	17
Figure 3.1: Section - Champions Way Linear Park	21
Figure 4.1: Graphs - Total Development Summary by Use	33
Figure 4.2: Summary Table	33
Figure 4.3: Graphs - North Area Development Summary by Use	34
Figure 4.4: North Area Summary Table	34
Figure 4.5: North Area Block reference map	34
Figure 4.6: Graphs - South Area Development Summary by Use	35
Figure 4.7: South Area Summary Table	35
Figure 4.8: South Area Block reference map	35

APPENDIX 02

# Network Categorization & Street Sections

## Network Categorization Key Map

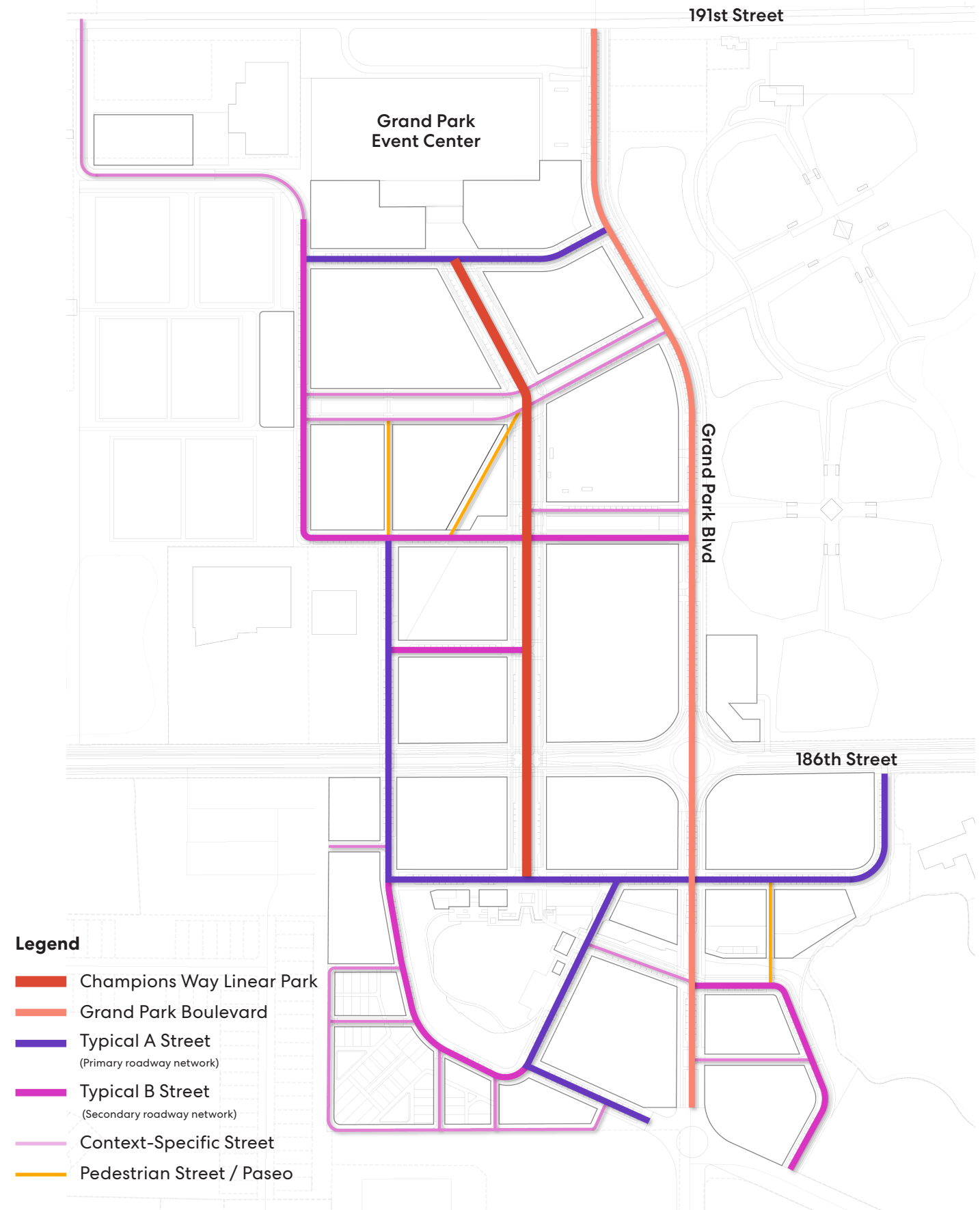

# Street Sections

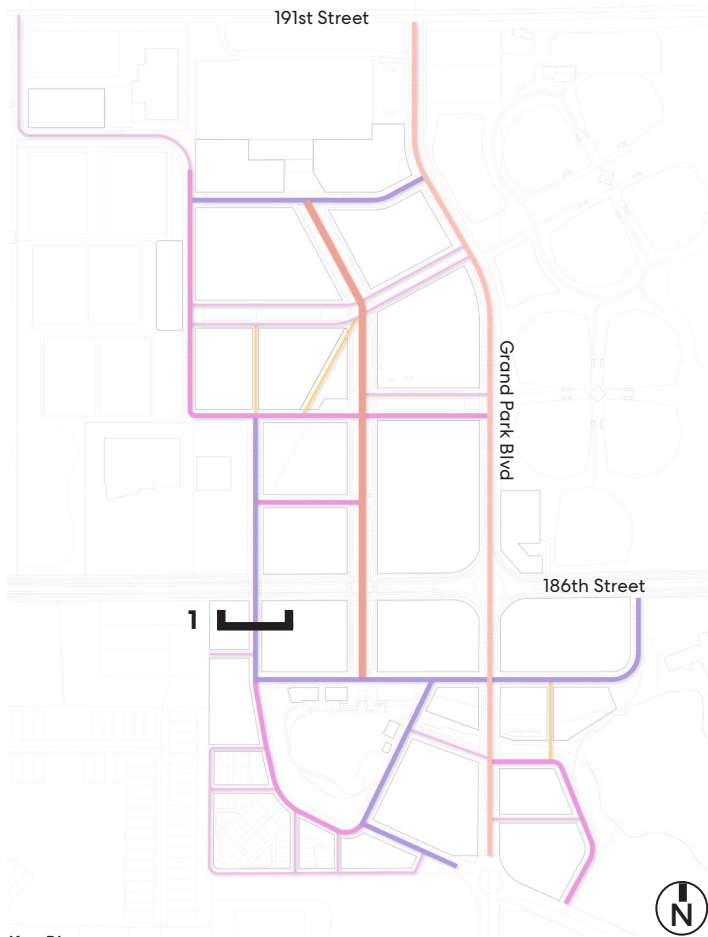

- Key Plan**
- Champions Way Linear Park
  - Grand Park Blvd
  - Typical A Street
  - Typical B Street
  - Context-Specific Street
  - Pedestrian Street / Paseo



Section 1: Typical "A" Type Street

# Street Sections

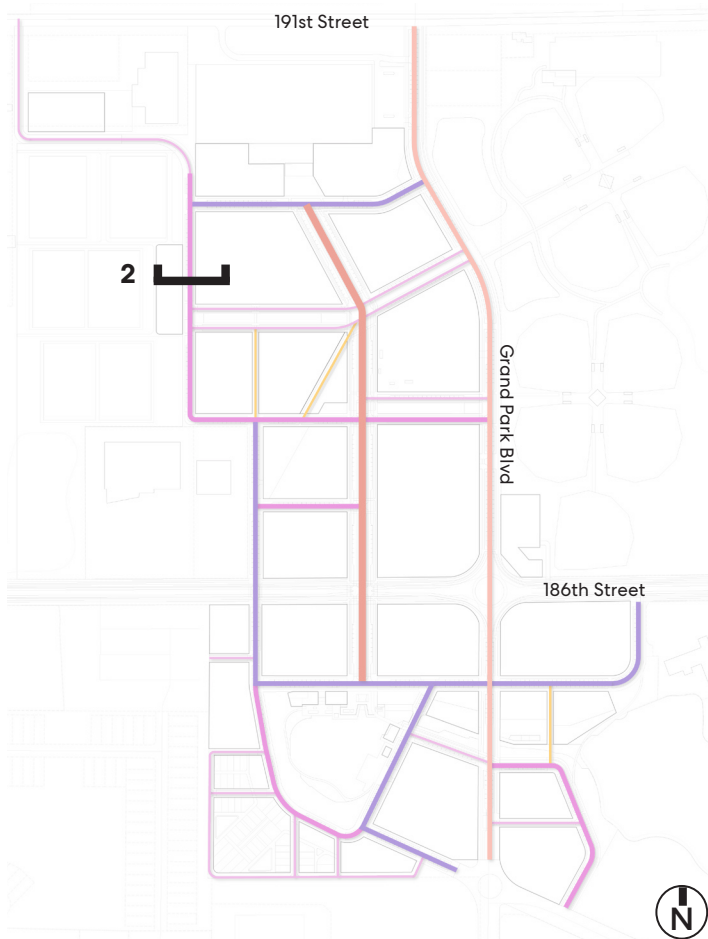

- Key Plan**
- Champions Way Linear Park
  - Grand Park Blvd
  - Typical A Street
  - Typical B Street
  - Context-Specific Street
  - Pedestrian Street / Paseo

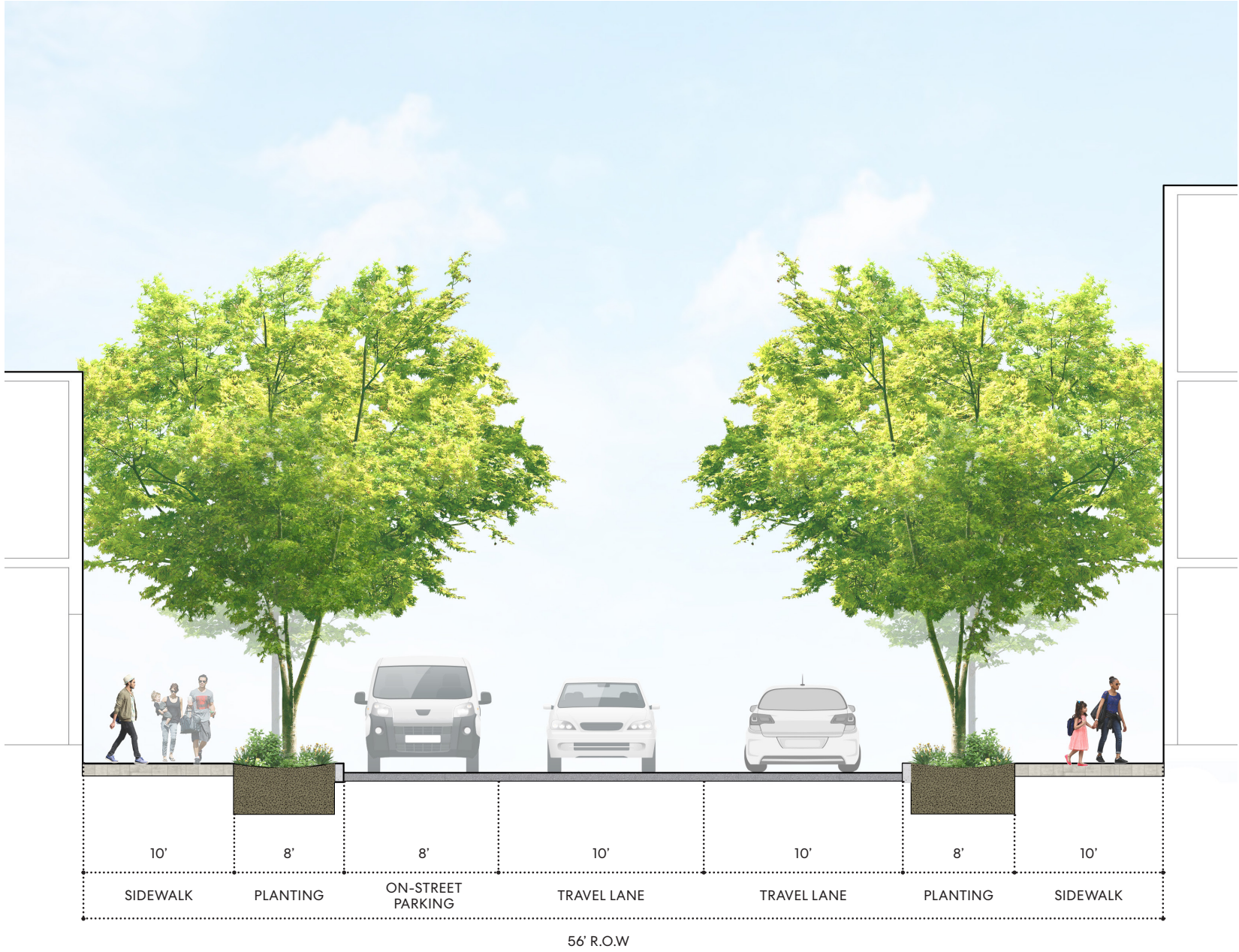

Section 2: Typical "B" Type Street

# Street Sections



- Key Plan**
- Champions Way Linear Park
  - Grand Park Blvd
  - Typical A Street
  - Typical B Street
  - Context-Specific Street
  - Pedestrian Street / Paseo



Section 3: Linear Park

# Street Sections

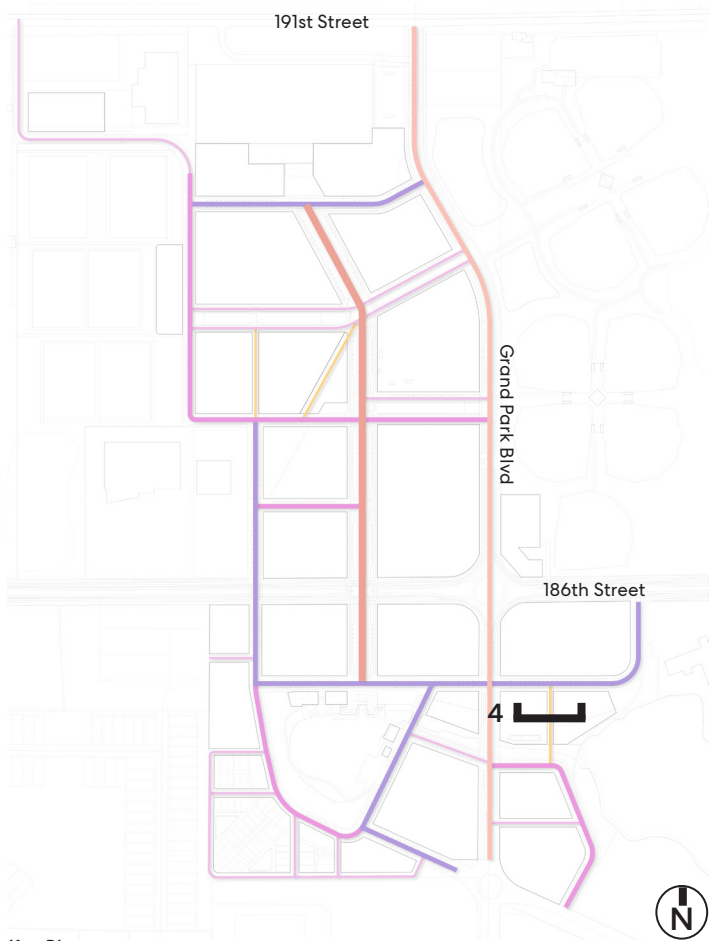

- Key Plan**
- Champions Way Linear Park
  - Grand Park Blvd
  - Typical A Street
  - Typical B Street
  - Context-Specific Street
  - Pedestrian Street / Paseo



Section 4: Pedestrian Paseo

# Street Sections

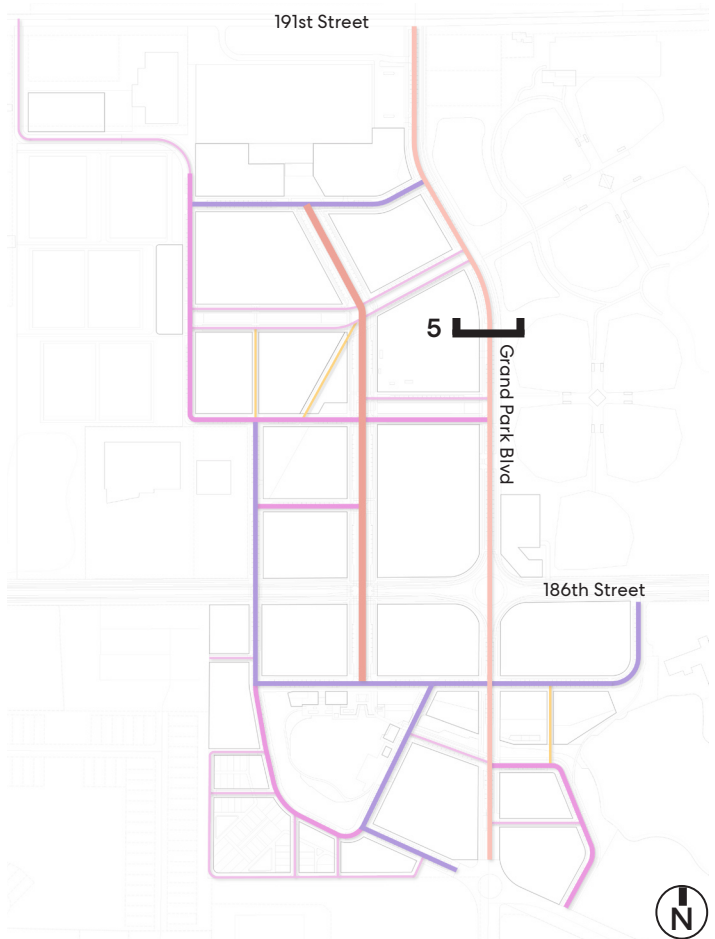

- Key Plan**
- Champions Way Linear Park
  - Grand Park Blvd
  - Typical A Street
  - Typical B Street
  - Context-Specific Street
  - Pedestrian Street / Paseo



Section 5: Grand Park Blvd (North)

# Street Sections

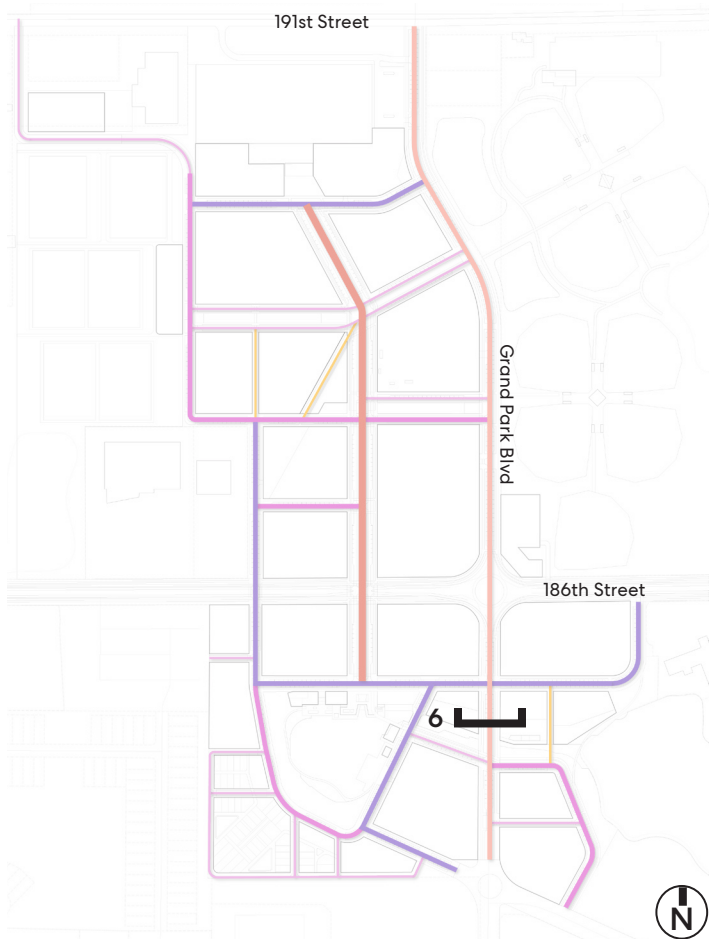

- Key Plan**
- Champions Way Linear Park
  - Grand Park Blvd
  - Typical A Street
  - Typical B Street
  - Context-Specific Street
  - Pedestrian Street / Paseo

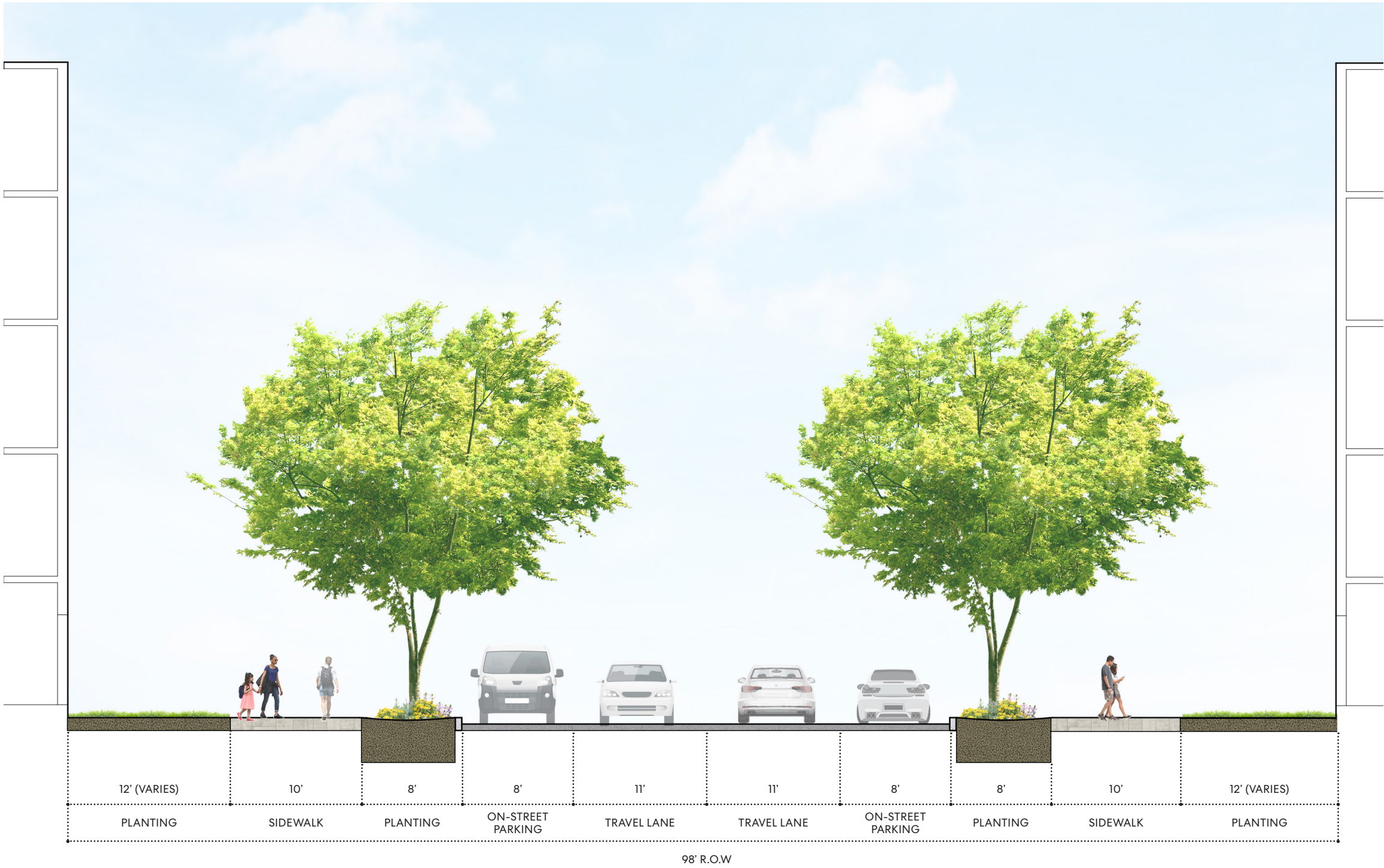

Section 6: Grand Park Blvd (South)

# Street Sections

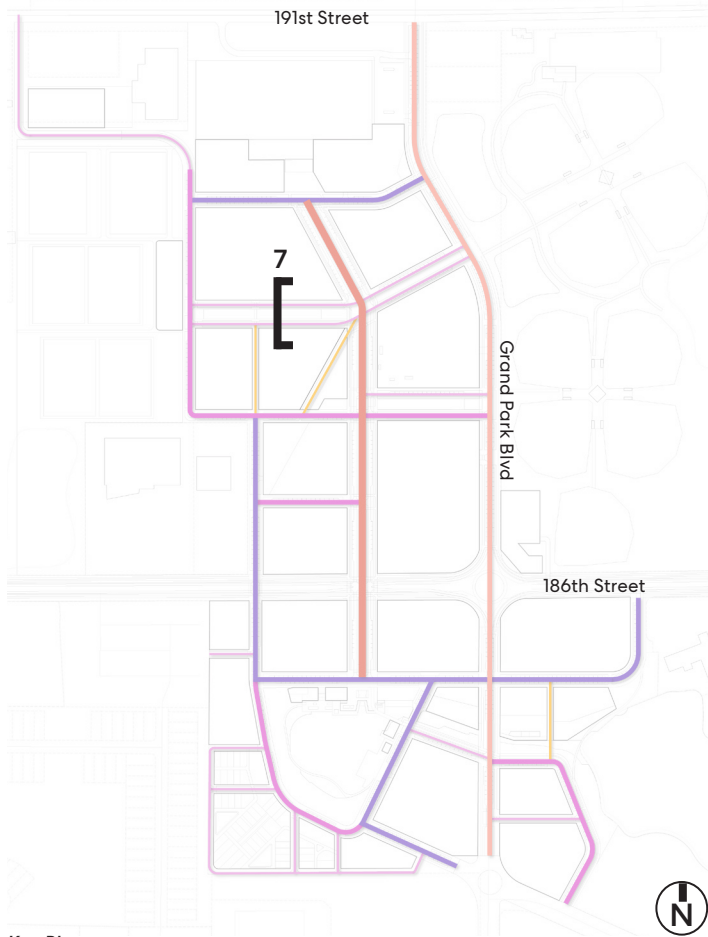

- Key Plan**
- Champions Way Linear Park
  - Grand Park Blvd
  - Typical A Street
  - Typical B Street
  - Context-Specific Street
  - Pedestrian Street / Paseo

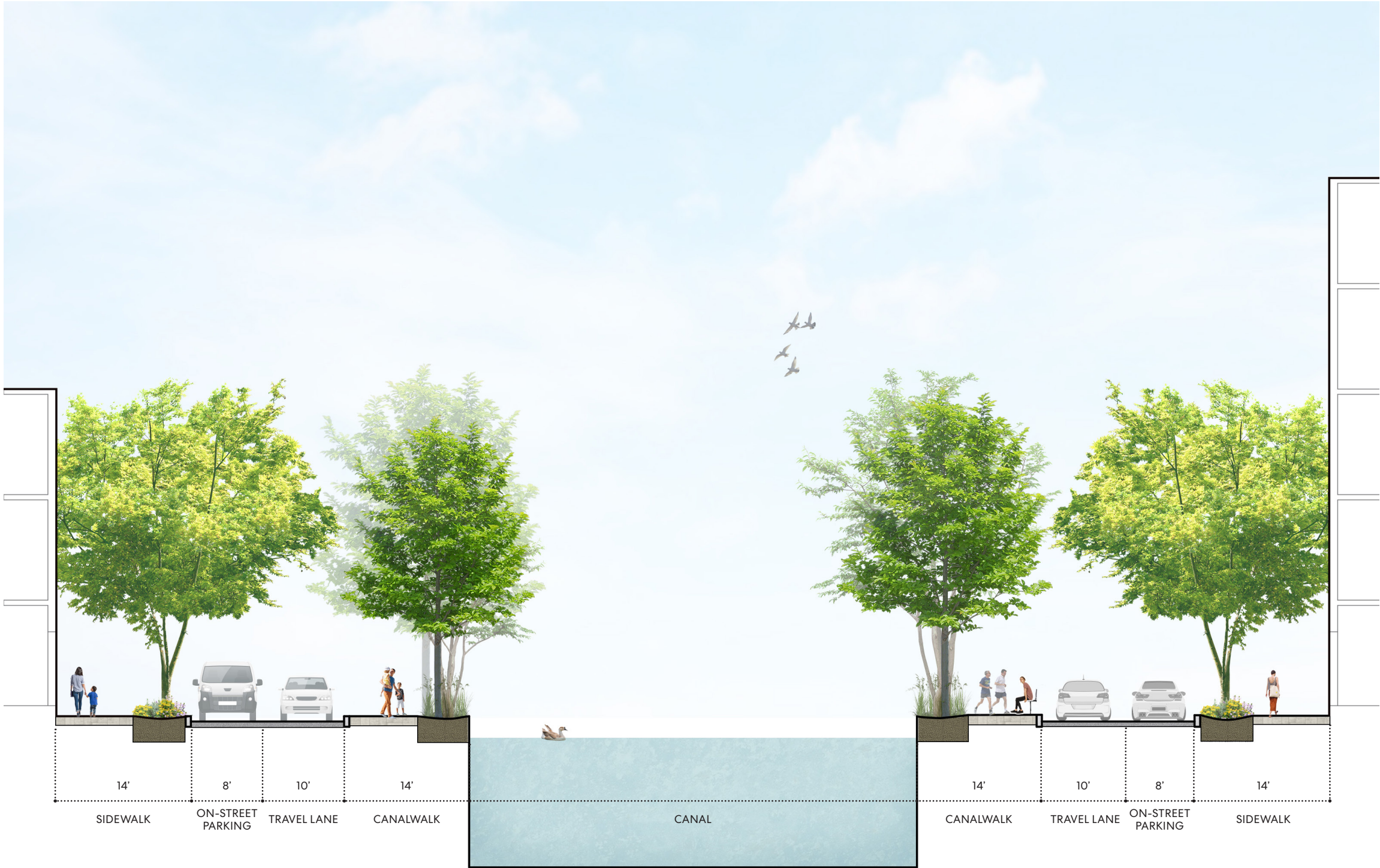

Section 7: Typical North Area Canal

# Street Sections

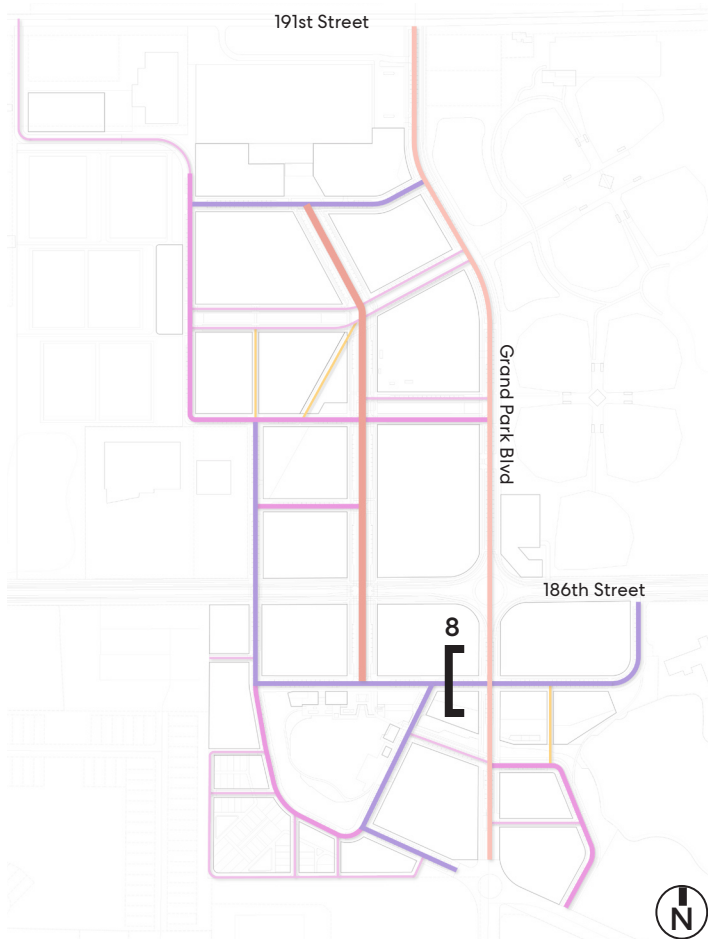

- Key Plan**
- Champions Way Linear Park
  - Grand Park Blvd
  - Typical A Street
  - Typical B Street
  - Context-Specific Street
  - Pedestrian Street / Paseo



Section 8: Retail Canalwalk #1 (South)

# Street Sections



Indianapolis Canal Walk



Oklahoma City Canal Walk



San Antonio Riverwalk

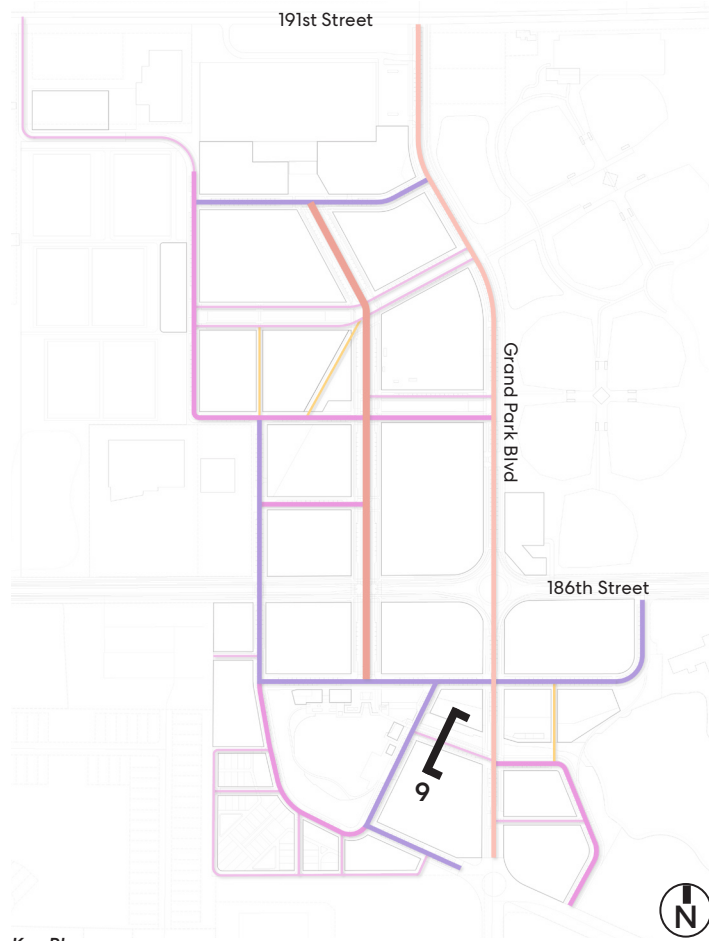

**Key Plan**

- █ Champions Way Linear Park
- █ Grand Park Blvd
- █ Typical A Street
- █ Typical B Street
- █ Context-Specific Street
- █ Pedestrian Street / Paseo

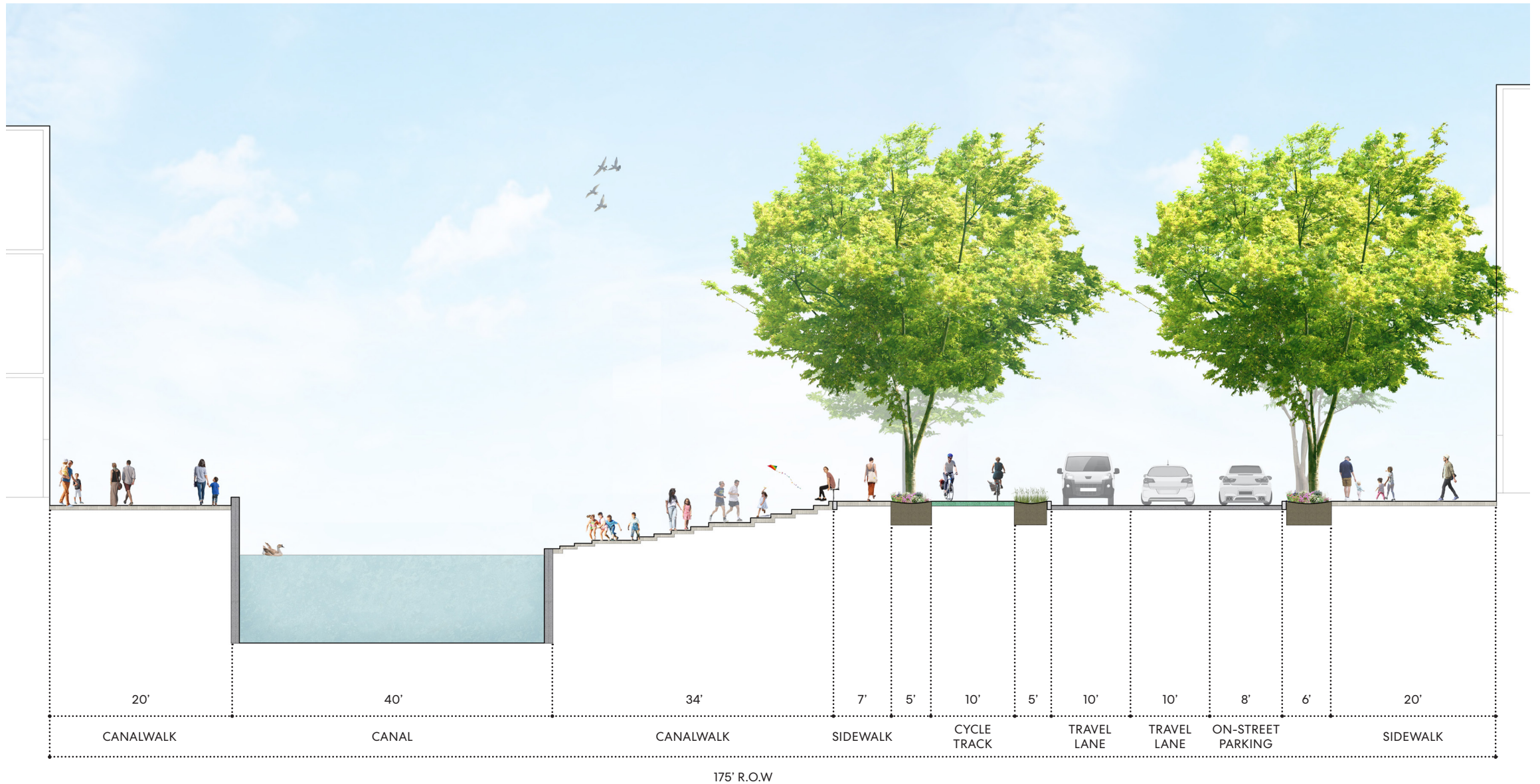

Section 9: Retail Canalwalk #2 (South)

# Street Sections

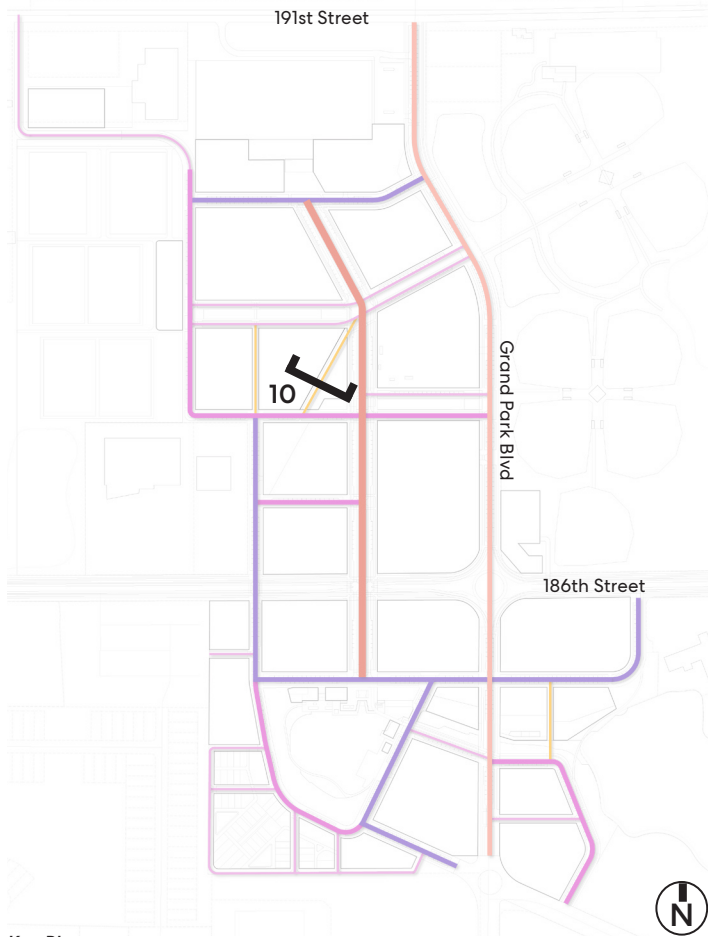

- Key Plan**
- Champions Way Linear Park
  - Grand Park Blvd
  - Typical A Street
  - Typical B Street
  - Context-Specific Street
  - Pedestrian Street / Paseo



Section 10: North Area Utility Easement - Paseo Condition

# Street Sections

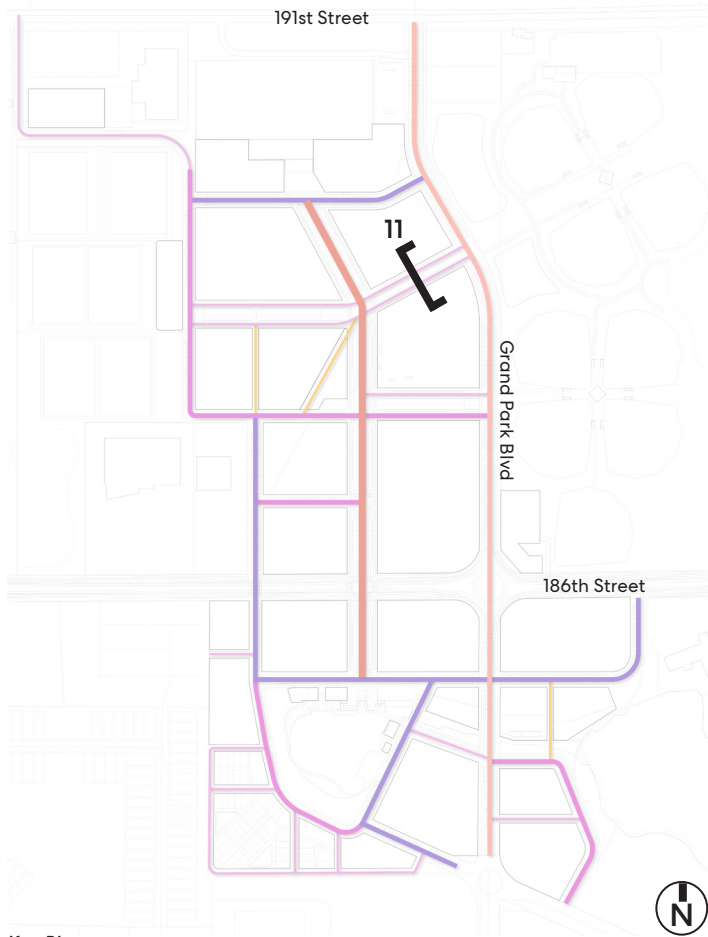

- Key Plan**
- Champions Way Linear Park
  - Grand Park Blvd
  - Typical A Street
  - Typical B Street
  - Context-Specific Street
  - Pedestrian Street / Paseo



Section 11: North Area Utility Easement - Boulevard Condition

APPENDIX 03

# Linear Park Programming Concepts Exhibit

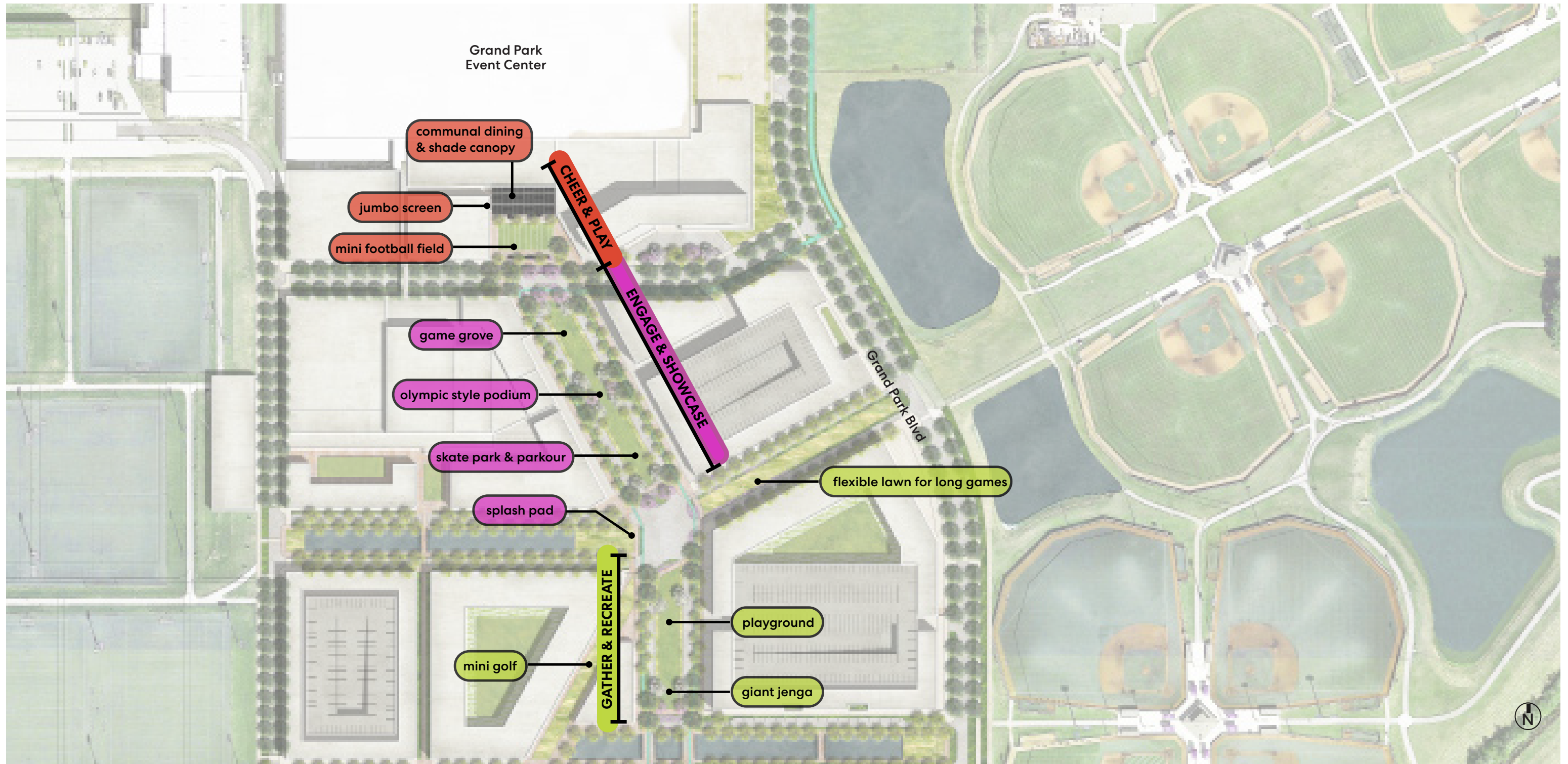

### 04 - Linear Park Programming Concept Exhibit (continued)



APPENDIX 04

# Gateway & Vista Terminations

## Brand & Identity Examples



Median Signage - North Park in San Diego, CA



Atlanta Braves Plaza - The Battery Development, Atlanta, GA



Power & Light District Building Signage - Kansas City



Parson's Alley Signage - Duluth, GA



The Yard Signage - Austin, TX



Atlanta Battery Signage - Atlanta, GA

## 04 - Gateways & Vista Terminations

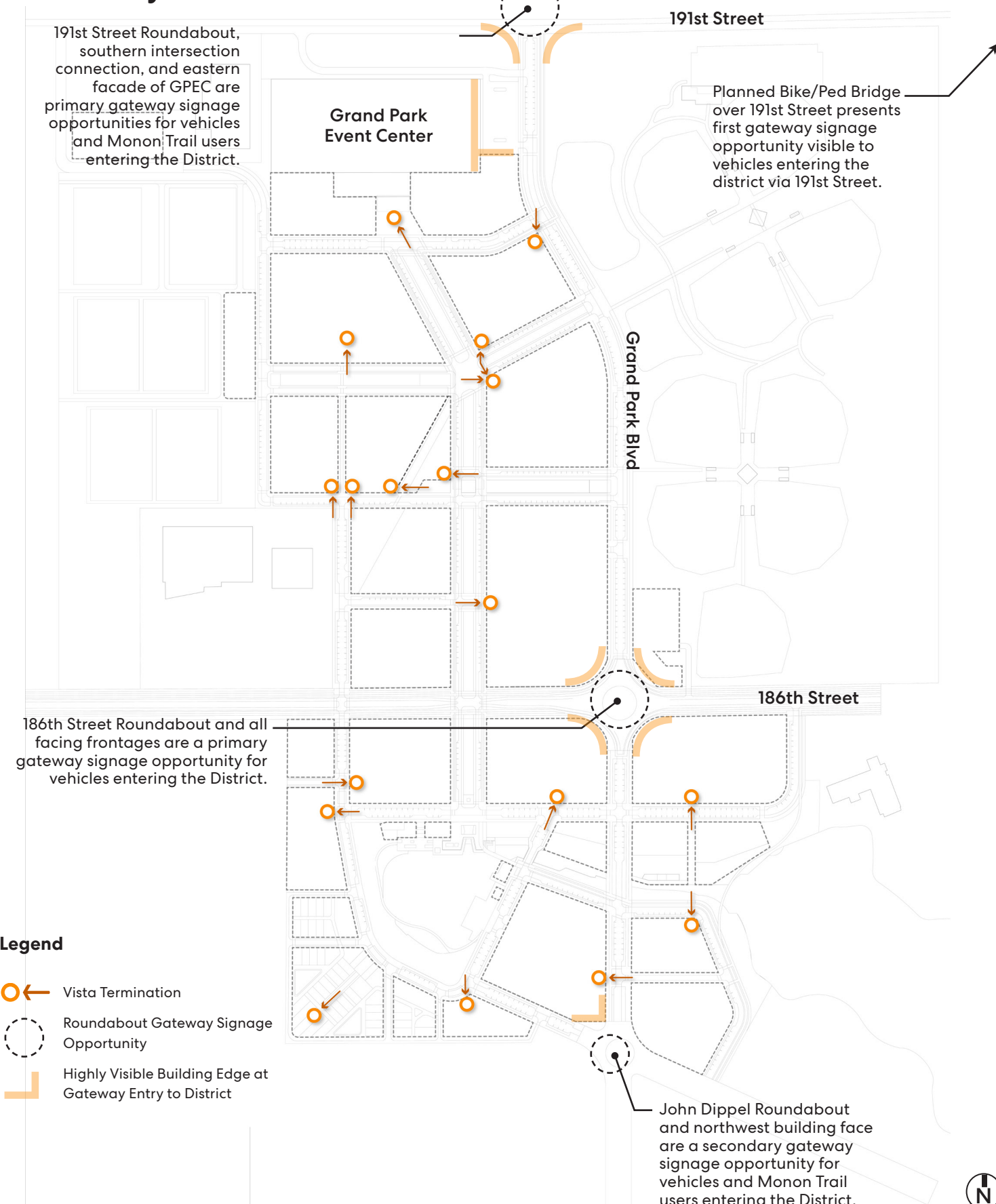

### APPENDIX 05

# 2024 Parcel Framework Plans

## North Area

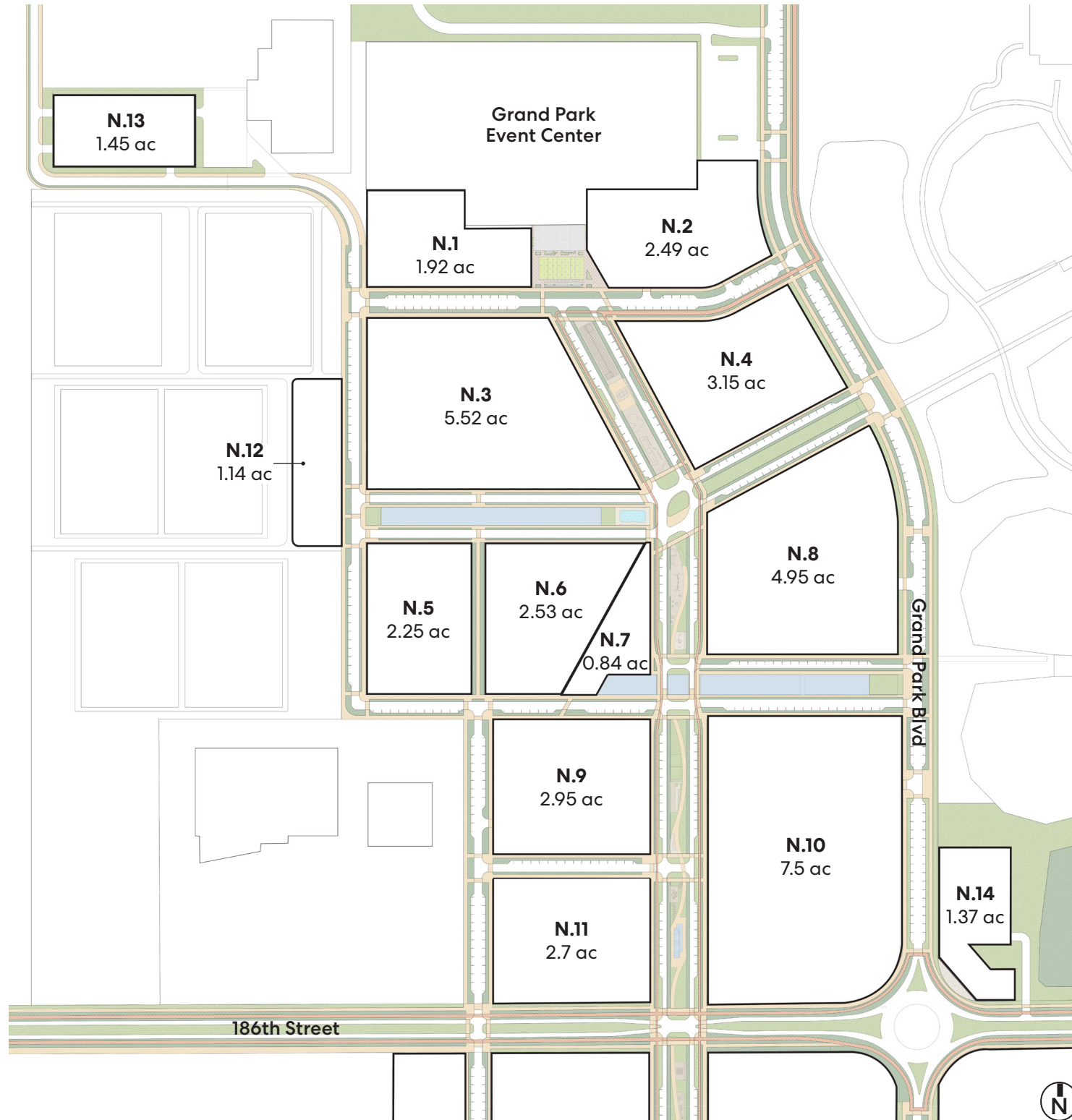

## 05 - 2024 Plan Parcel Framework Plan - South Area

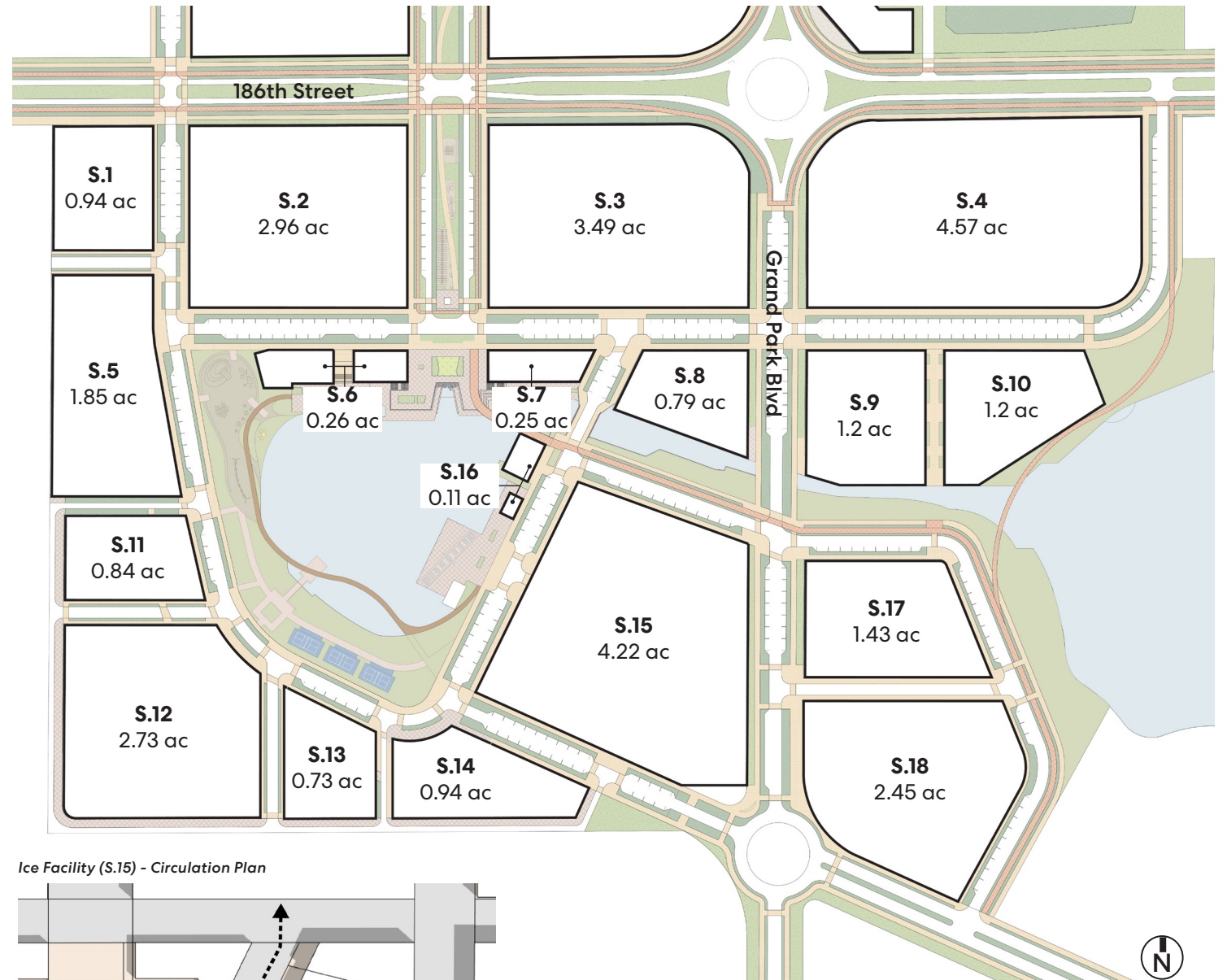

Ice Facility (S.15) - Circulation Plan

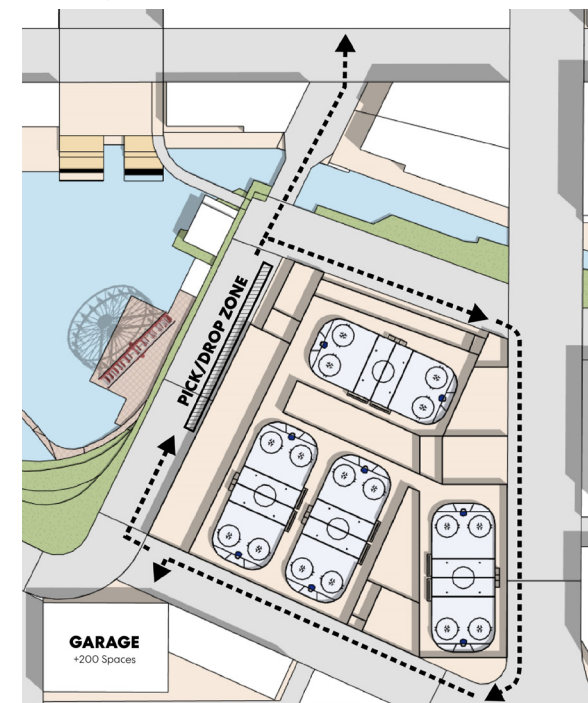

APPENDIX 06

# 2026 Updated Parcel Framework Plans

## Parcel Framework Plan - South

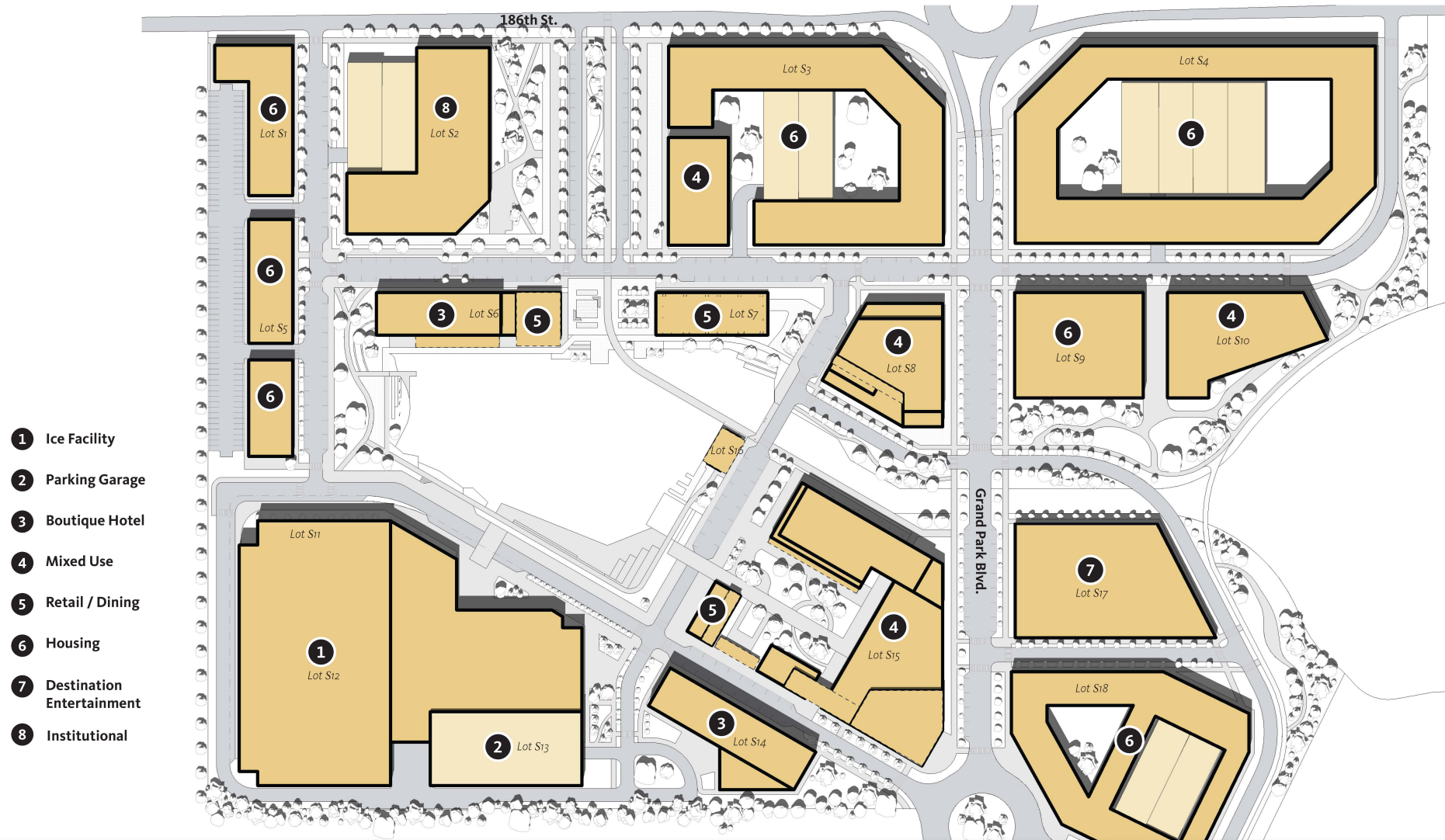

## Parcel Framework Plan - North

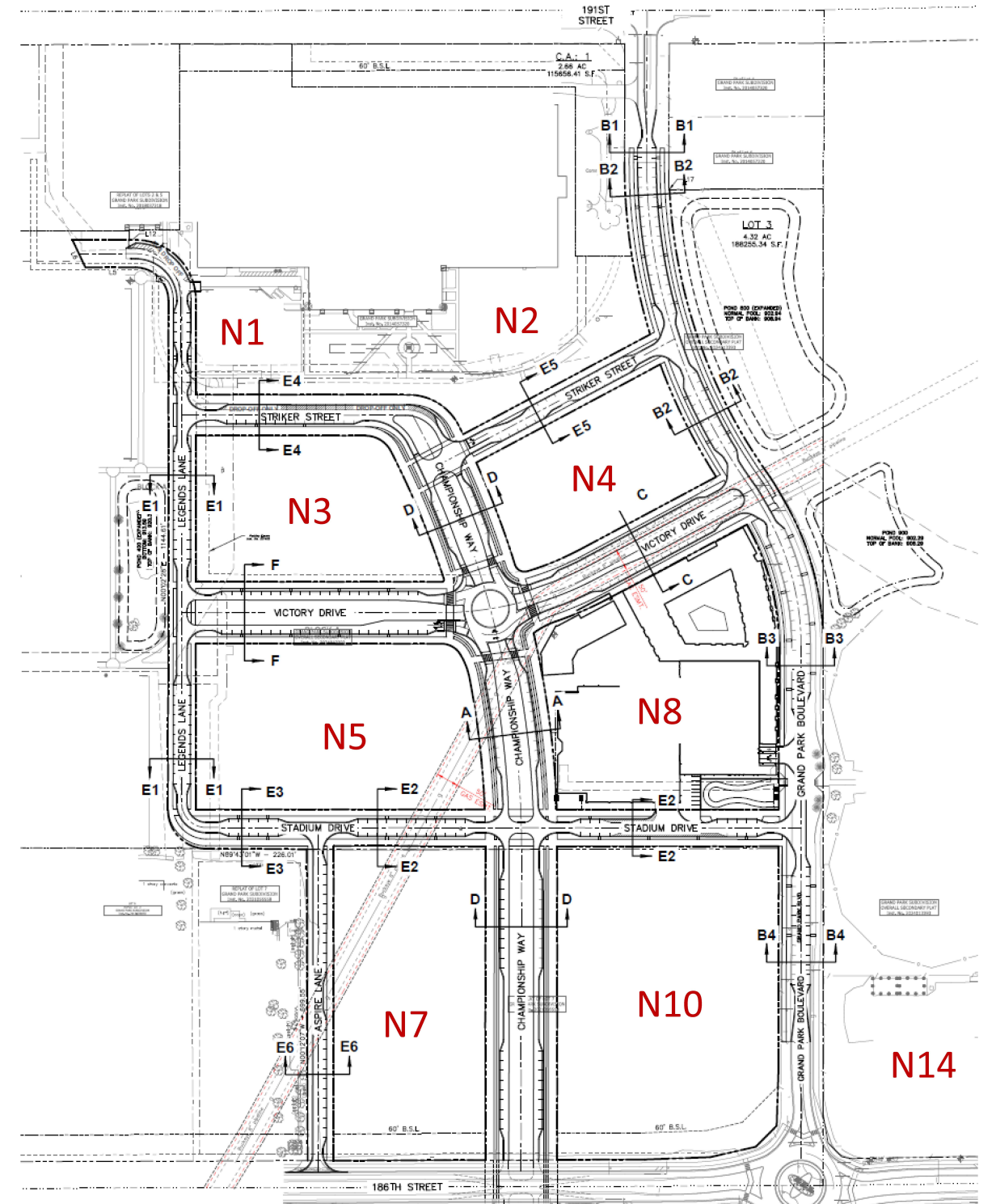

## APPENDIX 07

# GPEC, Hotel, Office - Massing Concepts



Concepts developed following  
(Workshop 2 - Oct 2024)

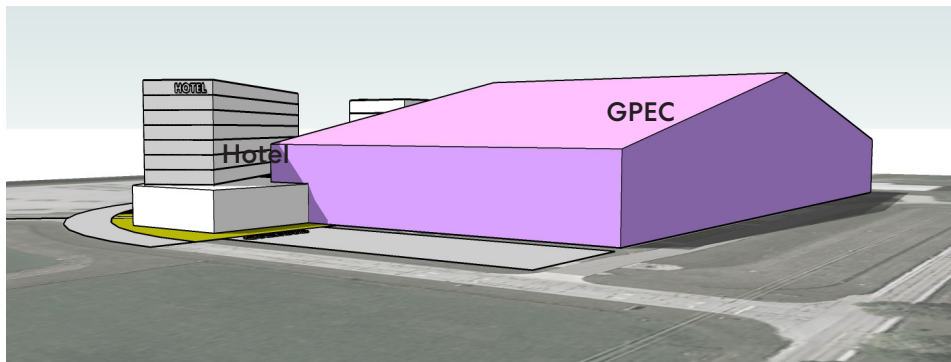
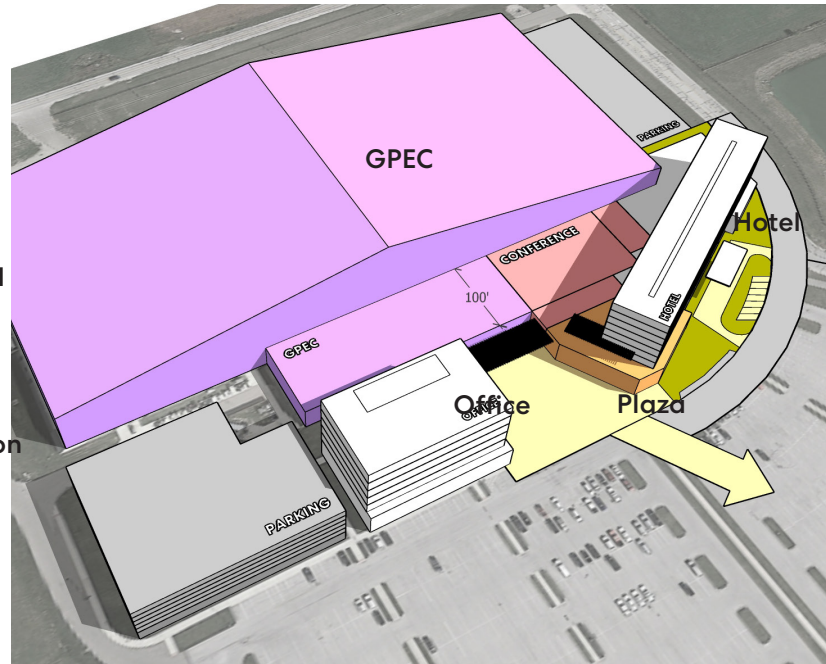
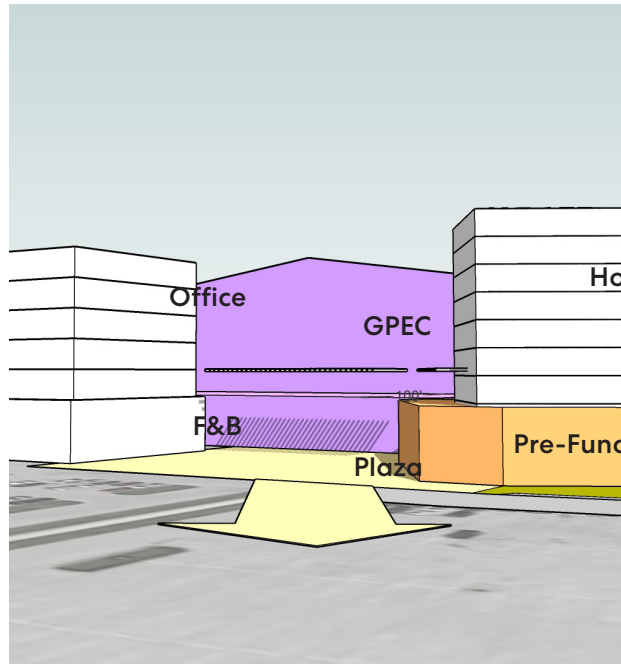

## APPENDIX 08

# Winter Activation Concept Examples



Boat Trail of Lights - Austin, TX



Cross County Center (Ice Skating Rink) - Yonkers, NY



Garden Igloos - Fort Lauderdale, FL



Beaverton Winter Lights - Beaverton, Oregon



Austin Trail of Lights - Austin, TX